

AERODROME CHART - ICAO

BIRK - REYKJAVIK

ARP 64°07'48"N
021°56'26"W
AERODROME ELEV 45
ELEV AND ALT IN FT MSL
DIST IN NM
VAR 12° W 2022 (Annual change -0,3° W)

APP 119.000	TWR/AFIS 118.000
GND 121.700	ATIS 128.100

RWY DESIGNATOR NR	TRUE & MAG BRG	THR PSN Geoid undulation	Bearing strength	THR ELEV and highest ELEV of TDZ of precision APCH RWY	Declared distances				Remarks	Approach and runway lighting				
					TORA	TODA	ASDA	LDA		APCH	THR	VASIS (MEHT)	Edge	End
01	355.27° GEO 007° MAG	640721.64N 0215610.82W GUND 217 ft	PCN 35 /F/A/X/T ASPH	THR 23 ft	1677	1677	1677	1487	The paved area in front of THR (190 M) is available for take-off and the length is included in the declared distances for take-off on RWY 01	THR ID LGT FLG WHITE	LIH G	PAPI 3.5° (47.83 ft)	LIH W	LIH R
19	175.27° GEO 187° MAG	640809.50N 0215619.89W GUND 217ft	PCN 35 /F/A/X/T ASPH	THR 29 ft TDZ 42 ft	1567	1567	1567	1567	TWY ALFA 120 m from RWY centerline	B - BARETTE LIH W Crossbar 300 m THR ID LGT FLG WHITE	LIH G	PAPI 3.5° (47.87 ft)	LIH W	LIH R
13	116.29° GEO 128° MAG	640757.10N 0215719.29W GUND 217 ft	PCN 25 /F/A/X/T ASPH	THR 21 ft	1375	1375	1375	1230	The paved area in front of THR (145 M) is available for take-off and the length is included in the declared distances for take-off on RWY 13	RWY alignment beacon 200 m from THR THR ID LGT FLG WHITE	LIH G	PAPI 3.1° (48.23 ft)	LIH W	LIH R
31	296.31° GEO 308° MAG	640740.43N 0215602.09W GUND 217 ft	PCN 25 /F/A/X/T ASPH	THR 38 ft	1349	1349	1349	1165	The paved area in front of THR (184 M) is available for take-off and the length is included in the declared distances for take-off on RWY 31	THR ID LGT FLG WHITE	LIH G	PAPI 4.45° (58.59 ft)	LIH W	LIH R

* TKOF from paved end inside RESA

TWY NAME	WIDTH [M]	Surface Bearing Strength	Dry Marking			Remarks
			Centerline Holding	Edge Centerline	RGL Stopbar	
TWY G	8	ASPH PCN 15 F/A/X/T	NO YES	NO YES	NO YES	
TWY H1	15	ASPH PCN 25 F/A/X/T	NO YES	YES NO	YES NO	
TWY H2	30	ASPH PCN 15 F/A/X/T	NO YES	YES NO	YES NO	
TXL J1	15	ASPH PCN 10 F/A/X/T	NO YES	YES NO	YES NO	
TXL J2	10.5	ASPH PCN 10 F/A/X/T	NO YES	YES NO	NO NO	Helicopters not permitted on TXL J2
TXL J3	26	ASPH PCN 25 F/A/X/T	NO YES	YES NO	YES NO	
TXL J4	15	ASPH PCN 15 F/A/X/T	NO YES	YES NO	YES NO	
TWY K1, K3	15	ASPH PCN 25 F/A/X/T	NO YES	YES NO	YES NO	
TWY K2	18	ASPH PCN 35 F/A/X/T	NO YES	YES NO	YES NO	
TWY L1	15	ASPH PCN 25 F/A/X/T	NO YES	YES NO	YES NO	
TWY M1, M2	30	ASPH PCN 15 F/A/X/T	NO YES	YES NO	YES NO	
TWY R1, R2	15	ASPH PCN 15 F/A/X/T	NO YES	YES NO	YES NO	

RWY guard lights and sign only on the left side for traffic holding at R1. For all holding points: If not cleared to enter or cross, pilots must stop at the runway holding points and request clearance

Ground vehicle traffic crossing RWY. Multiple RWY exit/entry points on both sides of RWY 01/19

Taxi line from J3 known to be misleading and can lead pilot beyond holding line on RWY 31.

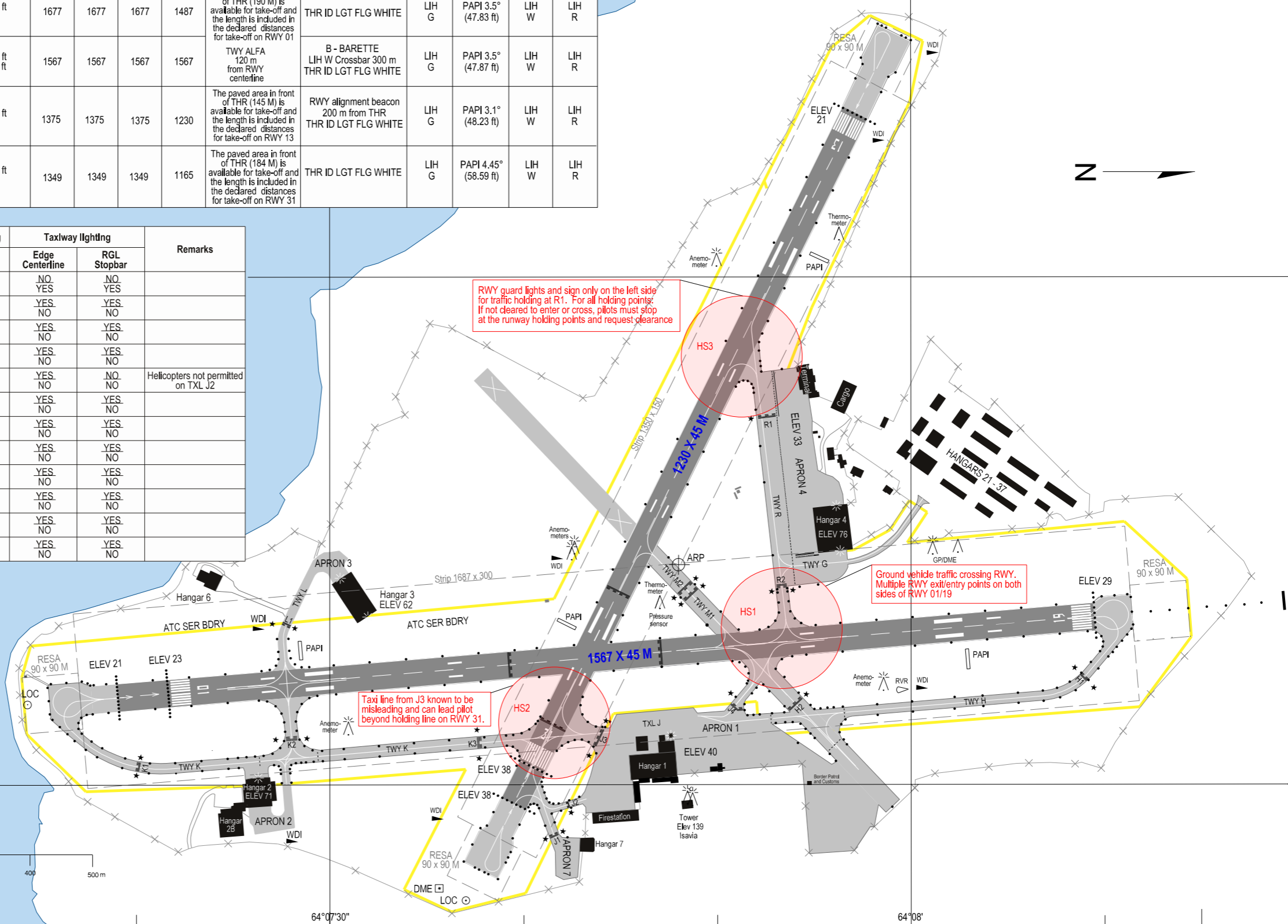

CAUTION: Bird concentration in the vicinity of the aerodrome. For further information see AD 2.23

ATC SER BDRY

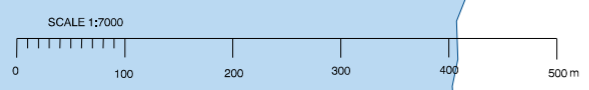

CHANGES: TWY J CHANGED TO TXL J

THIS PAGE INTENTIONALLY LEFT BLANK